

WORK TOP CONNECTOR

Material

Steel, bright zinc plated

Size

M6 x 65 mm	# 11.04.425
M6 x 100 mm	# 11.04.427
M6 x 150 mm	# 11.04.430
M6 x 200 mm	# 11.04.460

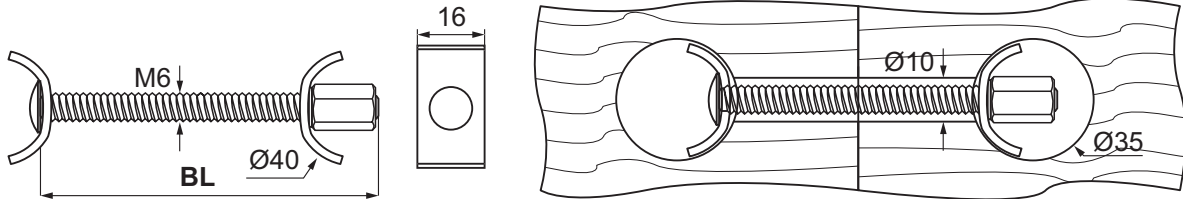
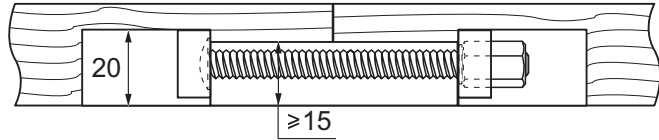

METAL CONNECTING SCREW F/Ø5 BORE

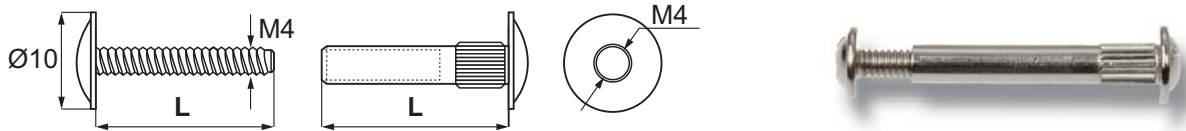

Panel thickness	Screw "L"	Tube "L"	NPL	BPL	BRZ	BLK
20 - 30 mm	M4 x 14 mm	M4 x 20 mm	# 11.06.730	available	upon request	upon request
25 - 35 mm	M4 x 14 mm	M4 x 25 mm	# 11.06.735	available	upon request	upon request
27 - 37 mm	M4 x 14 mm	M4 x 27 mm	# 11.06.740	available	upon request	upon request
30 - 40 mm	M4 x 17 mm	M4 x 27/30 mm	# 11.06.750	# 11.06.751	# 11.06.752	# 11.06.753

INDIVIDUAL COMPONENTS F/Ø5 BORE

TUBE M4 X Ø5 SIZES

L = 15, 20, 22, 25, 27, 30, 35, 40 mm	
L = 20 mm BPL	# 11.06.709
L = 27 mm NPL	# 11.06.716
L = 27 mm BRZ	# 11.06.713
L = 30 mm BLK	# 11.06.711
L = 35 mm NBL	# 11.06.756

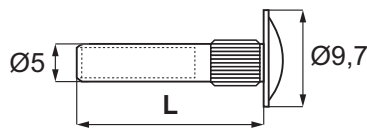

SCREW M4 SIZES

L = 10, 14, 18, 22, 25, 30, 35 mm	
L = 12 mm PLAIN	# 11.06.718
L = 14 mm BRZ	# 11.06.729

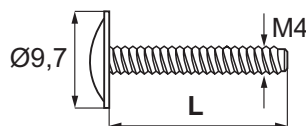

THREADED TUBE M4 X Ø5 MM

Diam. x L = 15, 22, 25, 30, 45, 50 mm

Material

Steel, yellow zinc plated

L = 15 mm	# 11.06.695
L = 22 mm	# 11.06.700
L = 30 mm	# 11.06.701



METAL CONNECTING SCREW F/Ø8 BORE

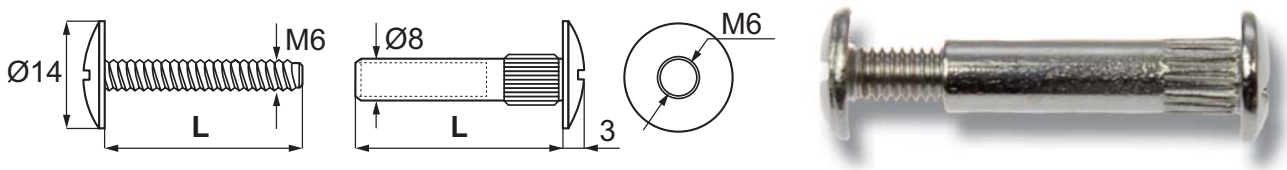

Panel thickness	Screw "L"	Tube "L"	NPL	BPL	BRZ	BLK
25 - 33 mm	M6 x 14 mm	M6 x 25 mm	# 11.06.902	# 11.06.901	# 11.06.900	
31 - 39 mm	M6 x 14 mm	M6 x 30 mm	# 11.06.912	# 11.06.913	# 11.06.910	
31 - 45 mm	M6 x 20 mm	M6 x 30 mm	# 11.06.904			available upon request
38 - 46 mm	M6 x 20 mm	M6 x 38 mm	# 11.06.920	# 11.06.922		

INDIVIDUAL COMPONENTS F/Ø8 BORE

TUBE M6 SIZES
 L = 12, 15, 20, 25, 28, 31, 38 mm

L = 14 mm NPL # 11.06.905
 L = 14 mm BPL # 11.06.907
 L = 14 mm BRZ # 11.06.908
 L = 20 mm NPL # 11.06.906

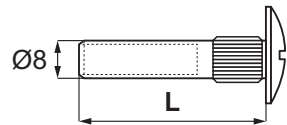

SCREW M6 SIZES
 L = 14, 20, 25, 30, 35, 45 mm

Upon request

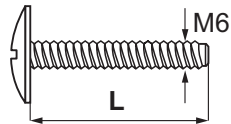

THREADED TUBE M6 X Ø8 MM
 L = 18, 20, 28 mm

Upon request

