

## "INVISIO" - KD SYSTEM

The patented "INVISIO" fastening System may be used in many different applications, such as cabinets, chairs and store fixtures

The system was developed to accomplish three specific objectives:

- To join panels securely together in such a manner that dimensional changes in the material or structure would not rupture or loosen the joints
- To achieve this objective with a fast and simple method of assembly, preferably without the need for tools
- To end up with a joint in which the fasteners are totally concealed



**Patented in US, Canada, EU, Turkey & China**



The "INIVISIO" Fastening system meets these objectives by utilizing a spring steel declining ramp "Clip" and a large collared "Shoulder Screw" as the two mating members. Spring steel makes the joints strong, yet flexible, while the collar on the Shoulder Screw adds tremendous resistance to torsional pull-out. Assembly occurs by simply sliding the Shoulder Screw head down the Clip's ramp.

With the Clip located in its pocket, and the system assembled, no fasteners are visible!

## SINGLE CLIPS – NON-LOCKING

Friction prevents the joint from disengaging.

**Material** Spring steel - black

Model No.	Panel thickness	Pocket width A	Item No.
4032	16 mm	11 mm	# 11.16.075
5032	19 mm	13,3 mm	# 11.16.135

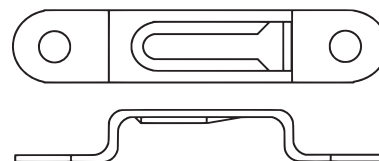

## SINGLE CLIPS – SEMI-LOCKING

Friction and a narrowing runway prevent the joint from disengaging. Requires more force to disengage than Non-locking clips.

**Material** Spring steel - black

Model No.	Panel thickness	Pocket width A	Item No.
4035	16 mm	11 mm	# 11.16.085
5032A	19 mm	13,3 mm	# 11.16.140

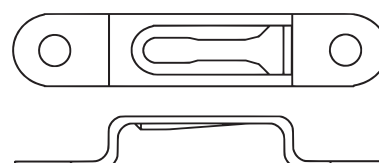

## SINGLE CLIPS – LOCKING

A locking tab prevents the joint from disengaging. Locking tab must be turned with a flat blade screw driver for disengagement.

**Material** Spring steel - black

Model No.	Panel thickness	Pocket width A	Item No.
4034	16 mm	11 mm	# 11.16.080
5031	19 mm	13,3 mm	# 11.16.130

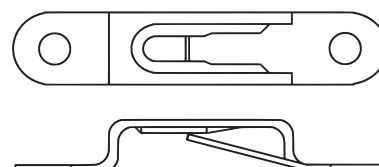

## SINGLE CLIPS – PASS-THRU

Used in grooved edge with another clip as an alternative to pockets with windows.

**Material** Spring steel - black

Model No.	Panel thickness	Pocket width A	Item No.
4031	16 mm	11 mm	# 11.16.074
5030	19 mm	13,3 mm	On request

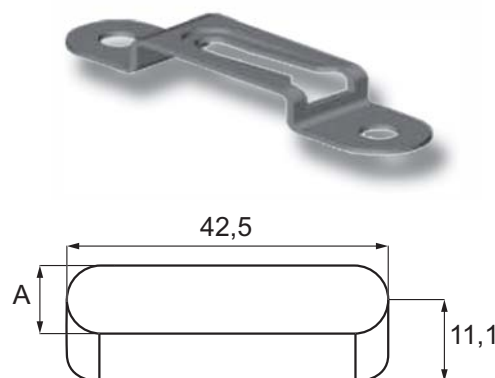
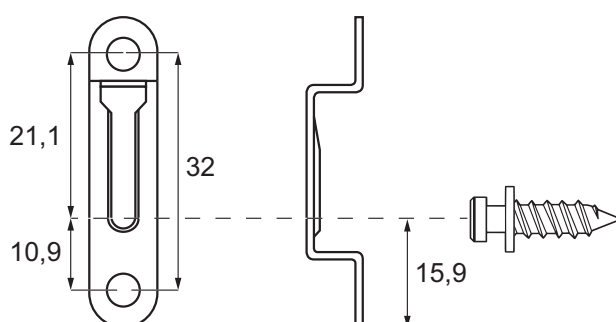
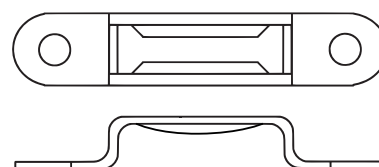

# SINGLE "low pocket depth" CLIPS F/"INVISIO" KD-SYSTEM

## SINGLE "low pocket depth" CLIPS – NON-LOCKING

Friction prevents the joint from disengaging.

**Material** Spring steel - black

Model No.	Panel thickness	Pocket width A	Item No.
4060	16 mm	11 mm	# 11.16.095
4061	19 mm	13,3 mm	# 11.16.100

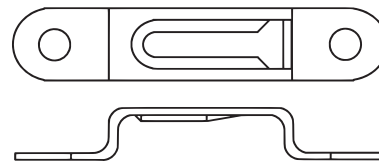

## SINGLE "low pocket depth" CLIPS – SEMI-LOCKING

Friction and a narrowing runway prevent the joint from disengaging.

Requires more force to disengage than Non-locking clips.

**Material** Spring steel - black

Model No.	Panel thickness	Pocket width A	Item No.
4062	16 mm	11 mm	# 11.16.105
4063A	19 mm	13,3 mm	# 11.16.110

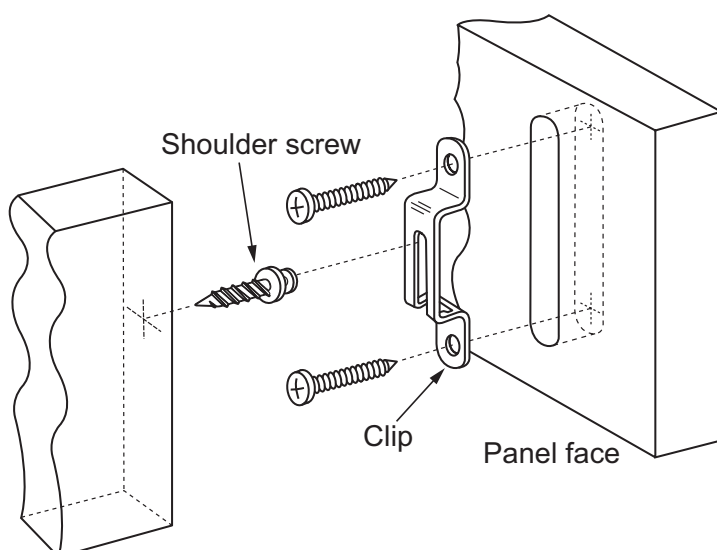
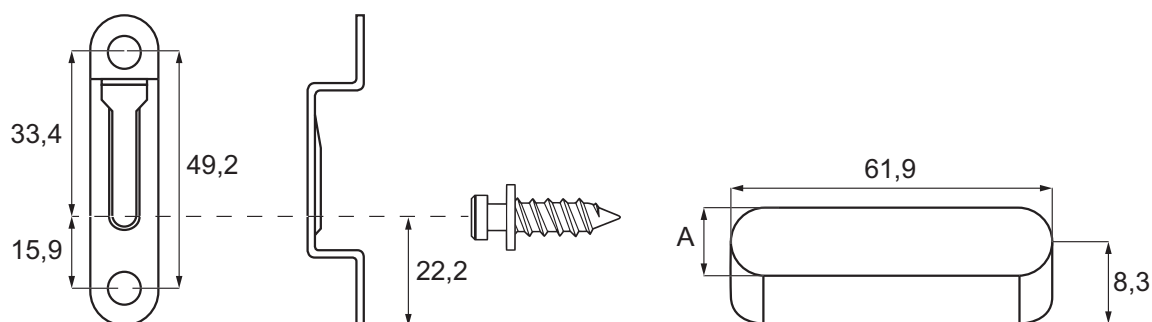
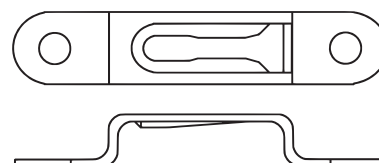

# DOUBLE CLIPS F/"INVISIO" KD-SYSTEM

- high quality furniture fittings

## DOUBLE CLIPS – NON-LOCKING

Friction prevents the joint from disengaging.

**Material** Spring steel - black

Model No.	Panel thickness	Pocket width A	Item No.
4036	16 mm	11 mm	# 11.16.255
5033	19 mm	13,3 mm	# 11.16.145

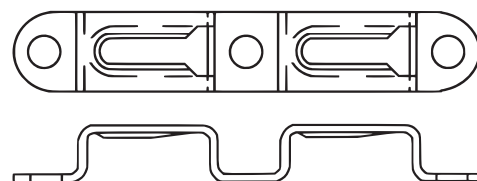

## DOUBLE CLIPS – SEMI-LOCKING/NON-LOCKING

Friction and a narrowing runway prevent the joint from disengaging.

Requires more force to disengage than Non-locking clips.

1 hole with semi-locking and 1 without locking

**Material** Spring steel - black

Model No.	Panel thickness	Pocket width A	Item No.
4037	16 mm	11 mm	# 11.16.260
5035	19 mm	13,3 mm	# 11.16.155

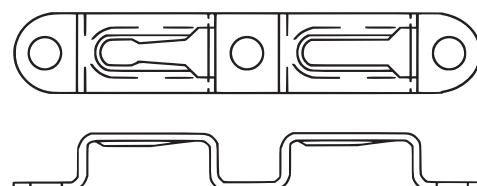

## DOUBLE CLIPS – LOCKING/NON-LOCKING

A locking tab prevents the joint from disengaging. Locking tab must be turned with a flat blade screw driver for disengagement.

1 hole with locking and 1 non locking

**Material** Spring steel - black

Model No.	Panel thickness	Pocket width A	Item No.
4038	16 mm	11 mm	# 11.16.265
5034	19 mm	13,3 mm	# 11.16.150

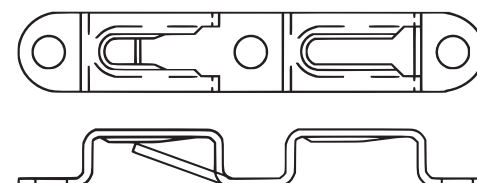

## DOUBLE CLIPS – PASS-THRU/NON-LOCKING

Used in grooved edge with another clip as an alternative to pockets with windows. 1 hole pass-thru and 1 non locking

**Material** Spring steel - black

Model No.	Panel thickness	Pocket width A	Item No.
4039	16 mm	11 mm	# 11.16.263
5039	19 mm	13,3 mm	# 11.16.158

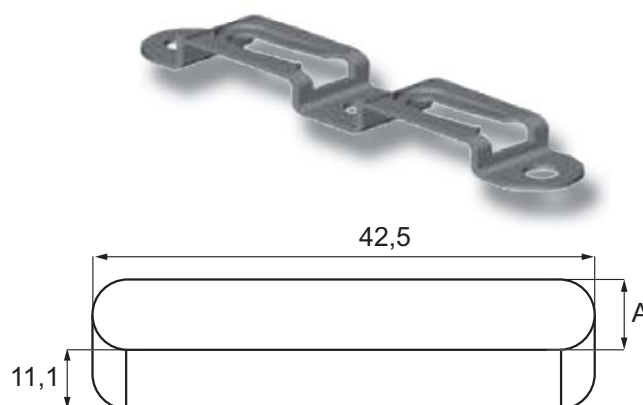
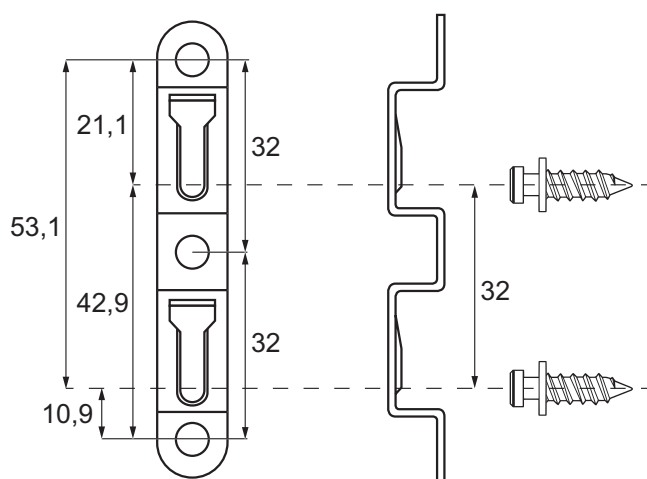
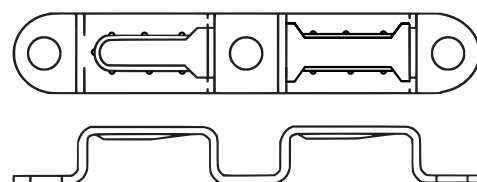

## BLUNT STEEL SCREWS

F/Ø 5 mm pre-drilled holes with windows.

Size	Model	Item No.
Ø 5 x 10 mm	2053	# 11.16.040
Ø 5 x 12,7 mm	2055	# 11.16.045

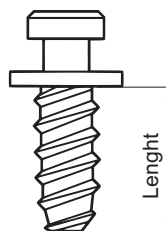

## POINTED STEEL SCREWS

F/Ø 4 & 5 mm pre-drilled holes.

Size	Model	Item No.
Ø 4 x 11 mm	5067	# 11.16.235
Ø 4 x 13 mm	1065	# 11.16.250
Ø 4 x 16 mm	1165	# 11.16.030
Ø 4 x 22 mm	5070	# 11.16.245
Ø 4 x 32 mm	5068	# 11.16.225
Ø 4 x 29 mm	5069	# 11.16.230
Ø 5 x 16 mm	2155	# 11.16.070
Ø 5 x 22 mm	6069	# 11.16.310

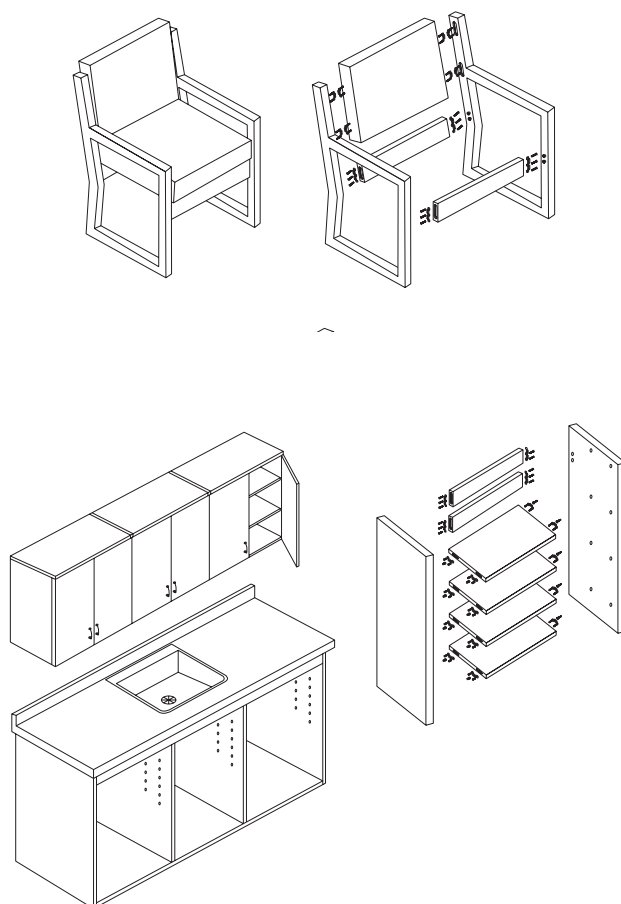
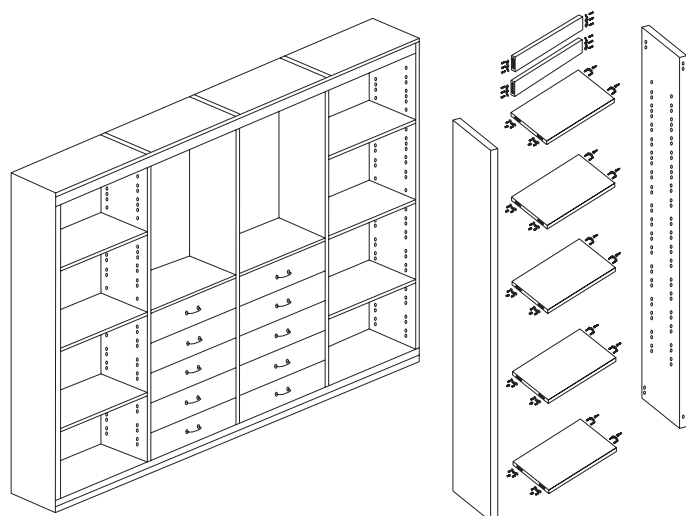
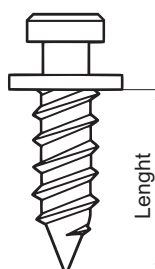

# "INVISIO" ANTI ROTATING CLIPS

- high quality furniture fittings

**SISO**  
DENMARK

The 32 mm anti rotating clips are designed to go into a rail with open pocket as narrow as 13 mm using the 2000 clip series and 19 mm using the 5000 clip series. It provides a tight concealed joint over a wide range of pocket depths.

It may be used in many different applications such as cabinets, chairs, tables & store fixtures.

The clip system is available in 2 versions. Non-locking and Locking.

## ANTI ROTATING CLIPS – NON-LOCKING

Friction prevents the joint from disengaging.

**Material** Spring steel - black

Model No.	Panel thickness	Pocket width A	Pocket width B	Item No.
2075 - male	16 mm	12,7 mm	14 mm	# 11.16.050
2076 - female	16 mm	12,7 mm	14 mm	# 11.16.051
5075 - male	19 mm	13,3 mm	12,1 mm	# 11.16.400
5076 - female	19 mm	13,3 mm	12,1 mm	# 11.16.401



## ANTI ROTATING CLIPS – LOCKING

A locking tab prevents the joint from disengaging. Locking tab must be turned with a flat blade screw driver for disengagement.

**Material** Spring steel - black

Model No.	Panel thickness	Pocket width A	Pocket width B	Item No.
5073 - male	19 mm	13,3 mm	12,1 mm	# 11.16.390
5074 - female	19 mm	13,3 mm	12,1 mm	# 11.16.391

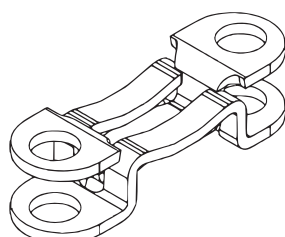
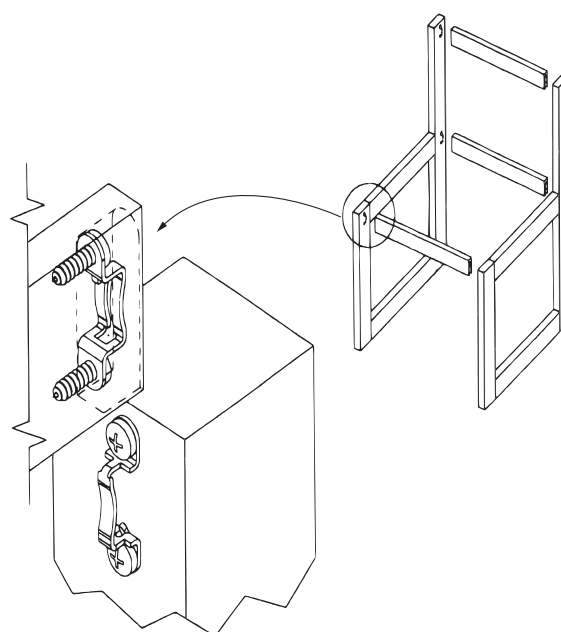
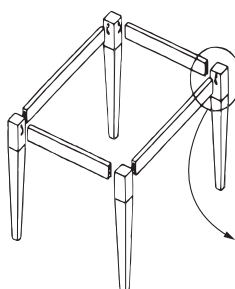
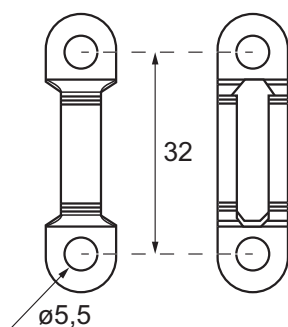
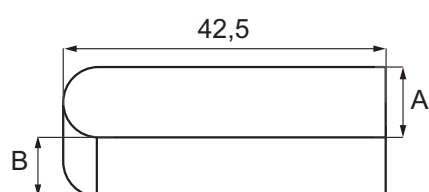

Open pocket

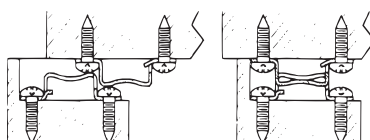

Closed pocket

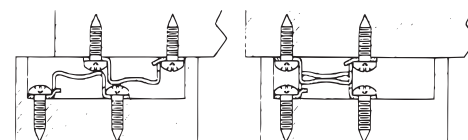

## COMPRESSION DOWELS

Compression dowels are just right for fastening decorative trim pieces like partition top caps, chair arms, toe kicks etc. Used with wood dowels, the compression dowels function as an internal clamp until the glue sets.

Surface mount dowels feature a closed end that can be screwed down with a #10 pan headed screw. This allows the dowel to stay fastened to the proper member during disassembly.

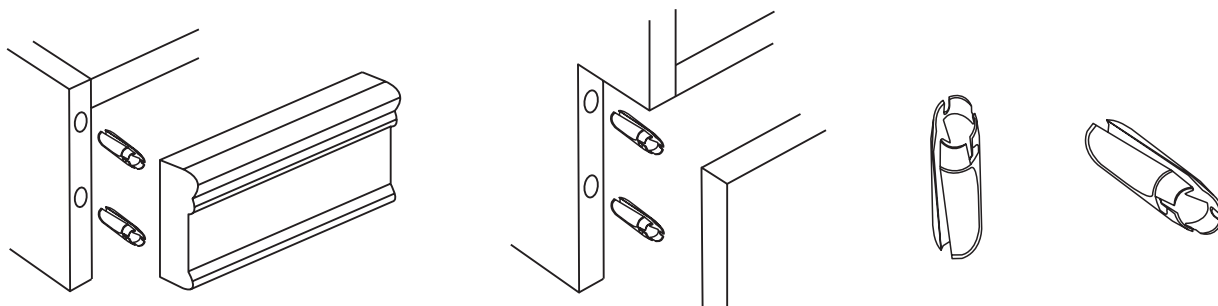

### COMPRESSION DOWELS

Material Spring steel - black		
Size	Model	Item No.
ø 6,4 x 28 mm	5052A	# 11.16.170
ø 8 x 35 mm	5053A	# 11.16.176
ø 11 x 31,8 mm	5055	# 11.16.180

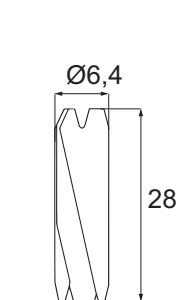

Drill hole ø6 mm

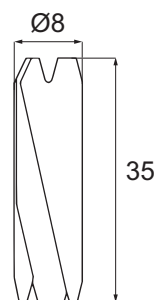

Drill hole ø8 mm

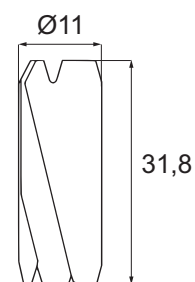

Drill hole ø10 mm



### COMPRESSION DOWELS – surface mounted – closed end

Material Spring steel - black		
Size	Model	Item No.
ø 11 x 28,6 mm	5055A	# 11.16.185

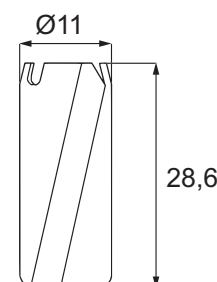
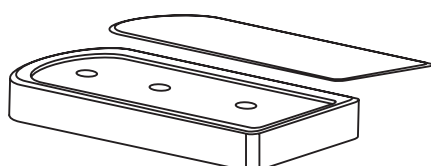

Drill hole ø10 mm